

# ATCHAM SUITE

The Atcham Suite's location to the daylight drenched Gallery, means that it is a great space for small to medium conferences and events, which would benefit from direct access to the Gallery for welcome drinks, lunch or access to an exhibition space.

The Atcham suite is a single, large room which benefits from the venue's approach to clean, brand-free décor.

ATCHAM	
<b>DIMENSIONS</b>	19.5 x 11.9m
<b>SIZE</b>	232m <sup>2</sup>
<b>HEIGHT</b>	3.5m
<b>THEATRE</b>	260
<b>CLASSROOM</b>	114
<b>BOARDROOM</b>	-
<b>RECEPTION</b>	300
<b>BANQUETING</b>	180
<b>CABARET</b>	120

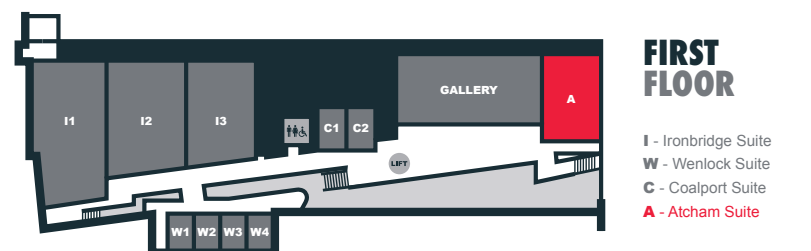
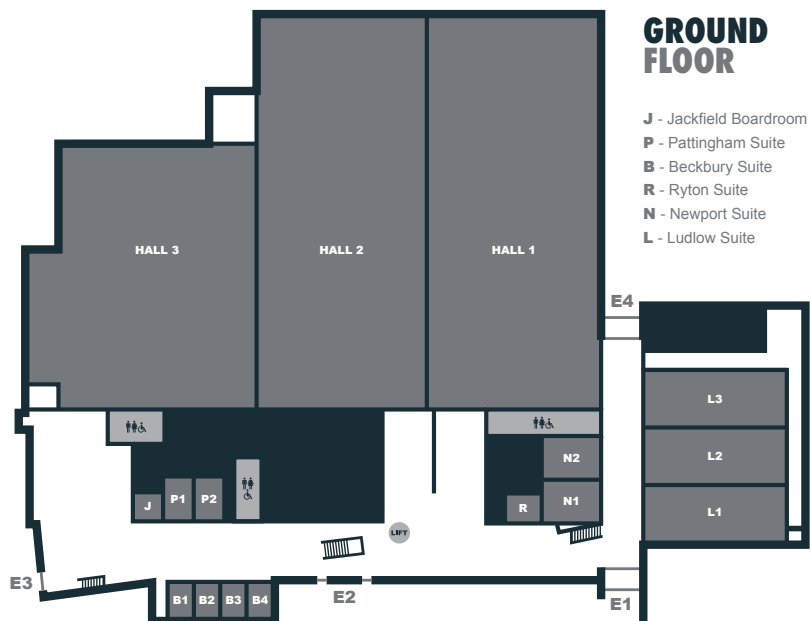

**TELFORD. EVENT. READY.**

